



247 Annies Lane, Woodhouselee Via Goulburn NSW

Great Home, Great Location

4 2 3

In a wonderful location just 15 minutes from Goulburn this 27 acre property has a masterbuilt home with no expense spared inside and out.

- * 4 large bedrooms with built in robes, main with ensuite and walk in robe.
- * Designer kitchen with stone bench tops and a 110cm black Richmond Deluxe Dual Fuel Range cooker and walk in pantry.
- * Ducted Mitsubishi Heavy Industries reverse cycle air conditioning and a slow combustion wood fire.
- * Approx 200,000 litre water tank storage.
- * 27 acres approx 75% cleared with 2 dams and 2 paddocks.
- * Shed with power and also living quarters.

Price : \$ 985,000
Land Size : 111700 sqm
View : <https://www.angellastorrierrealestate.com.au/sale/nsw/southern-tablelands/goulburn/residential/rural/7082584>

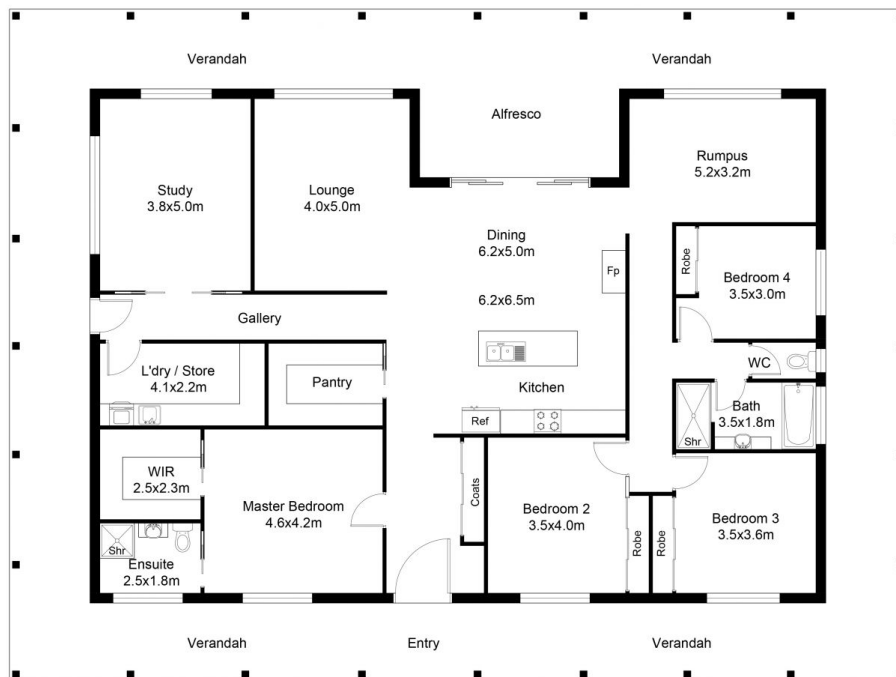

FLOOR PLAN

This floor plan including furniture, fixture measurements and dimensions are approximate and for illustrative purposes only. Bxbrownie.com gives no guarantee, warranty or representation as to the accuracy and layout. All enquiries must be directed to the agent, vendor or party representing this floor plan.

247 Annies Lane